



FTTH Fibre Outlet - TEN-FWO1 Installation Guide

Rev. 3.00/02.2024

Contents

Getting Started.....	1
Introduction	1
Package Contents.....	1
About the TEN-FWO1 Fibre Outlet	2
Product Specification	2
Mechanical Layout	2
Installation Instructions	3
General Preparations and Precautions	3
Preparation of the Incoming Optical Drop Cable.....	3
Installation Guidelines	3
Mounting Guidance	8
Legal Declarations	9

Getting Started

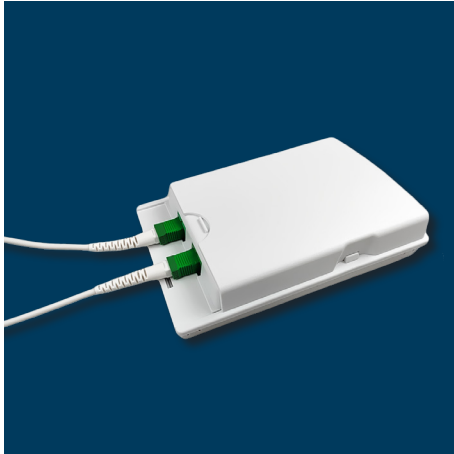

TEN-FW01 - Fibre Outlet

Introduction

Thank you for choosing this Teleste product. The TEN-FW01 is a modern and compact FTTH Fiber Outlet designed for indoor mounting at customer premises. Engineered for swift and easy installation, it acts as the interface between the network and the customer device. This guide will walk you through all the steps for a successful installation.

Package Contents

Kindly unpack the TEN-FW01 and confirm that all items are present, as illustrated in Figure 1. Should any items be missing, please promptly contact your local seller for assistance.

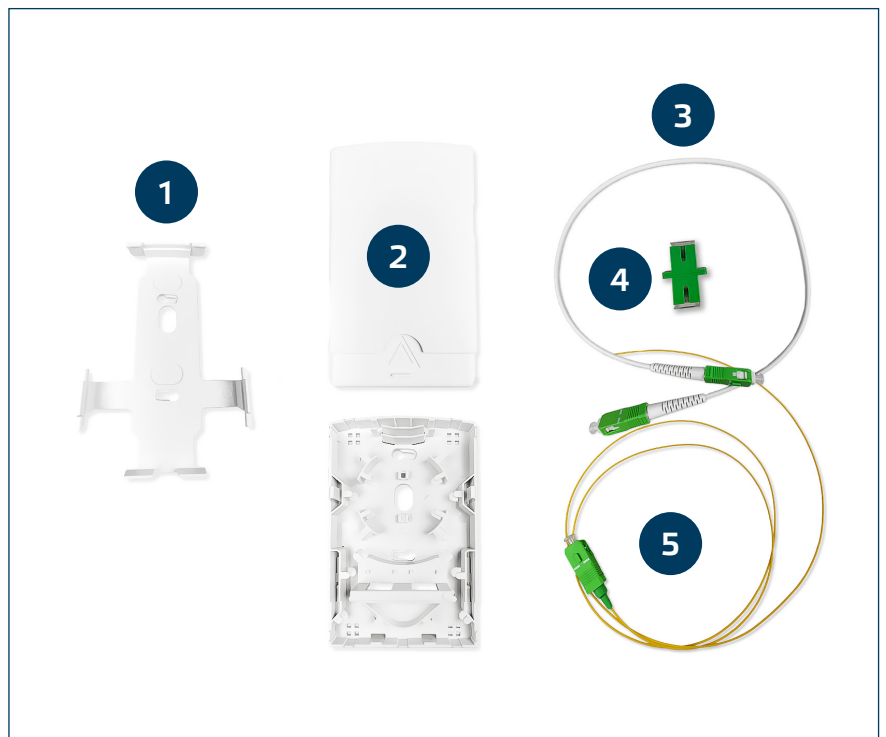

Figure 1 - Package contents

1. Bracket
2. TEN-FW01 - Fibre Outlet
3. FTTH Subscriber cable (optional)
4. Adapter (optional)
5. Pigtail (optional)

About the TEN-FWO1 Fibre Outlet

The TEN-FWO1 has been designed primarily for applications such as FTTH. The unit is very compact and easy to install along with convenient maintenance, it may be delivered empty, with pigtails, adapters and/or subscriber cable in a suitable box according to customer needs.

- Fixing hardware included.
- Accepts LC duplex or SC simplex adapters.
- Suitable for two adapters.

Product Specification

Dimension (LxWxH)	131 x 83 x 24 mm	Weight	0.084 kg
Material	ABS	Supported adaptors	SC, LC
Operating temperature	-40 - +85 °C	Colour	White (RAL9010)

Mechanical Layout

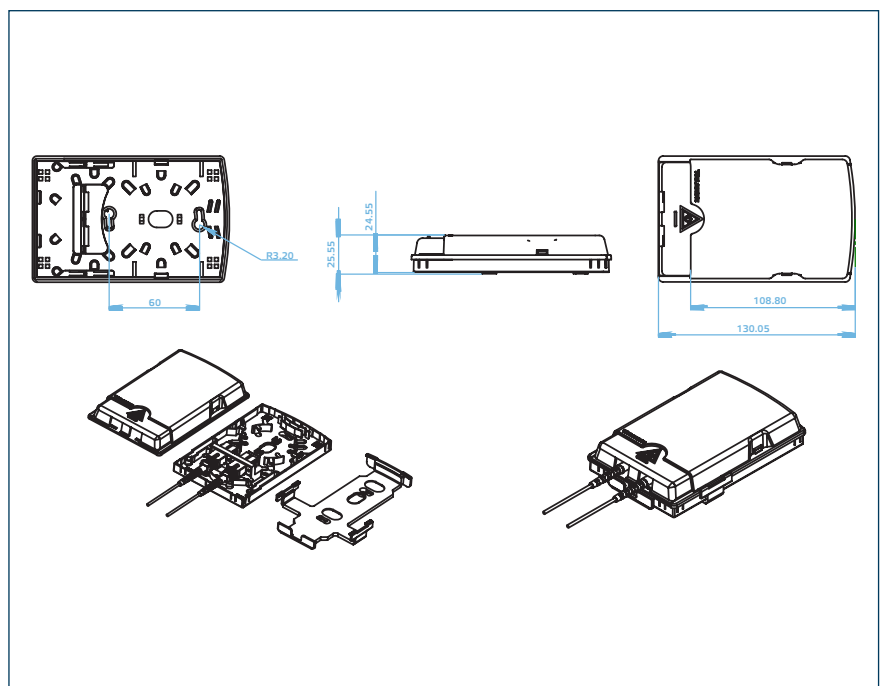

Figure 2 - Mechanical layout

Installation Instructions



Warning! *Ensure to follow basic safety precautions to reduce risk of fire, electrical shock, and personal injury.*

Thank you for choosing this Teleste product. Please take a moment and carefully read these instructions through before installing the product.

General Preparations and Precautions

1. Check the Fibre Outlet, cable items and all other components for any damages before installation.
2. Make sure to keep all components dry and clean for the installation.
3. Keep the working environment clean (dry and no dust) and flat for the installation.
4. Standard instruments and tools should be used during the installation.

Preparation of the Incoming Optical Drop Cable

1. Determine the length of cutting the drop cable.
2. Strip the drop cable accordingly.

Installation Guidelines

1. Begin by detaching the installation bracket from the product body.
2. Follow the procedure illustrated in Picture 1: Push to detach the bracket.
3. Secure the bracket onto the wall, at the location where you want to place the outlet after cable installation.

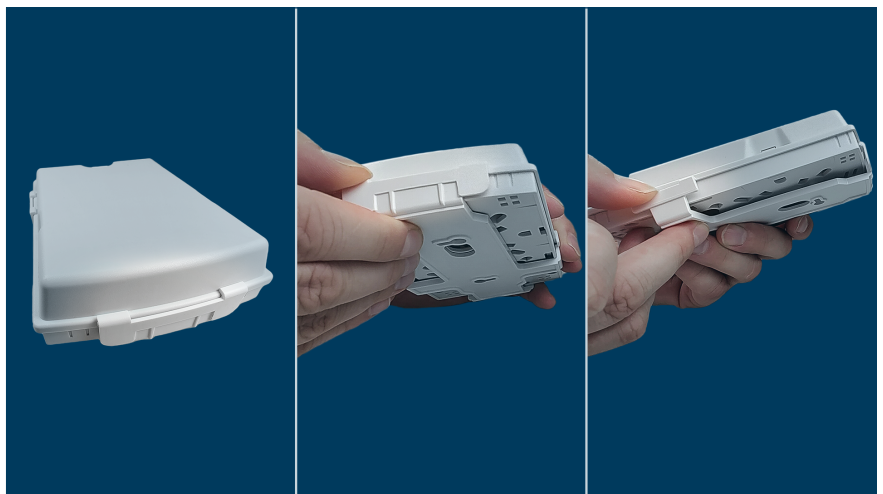

Picture 1



All necessary safety instructions must be followed during the installation and maintenance operations. The safety requirements for class 1M lasers are detailed in EN60825-1.

4. Press the pins on both sides of the TEN-FWO1 to unlatch and open the lid, see Picture 2.



Picture 2

5. The TEN-FWO1 accommodates multiple cable entry methods, as depicted in Picture 3. The yellow symbol represents an option where the incoming cable is threaded through the centre opening in the back plate, offering two cable tie fixing positions, as shown in Picture 4. The red symbols indicate positions where the cable can be conveniently routed through the side of the back plate and then secured. Cable tie fixings are provided next to each entrance opening, as shown in Picture 5. To utilize the side cable entry, remove the plastic clip covering it, as illustrated in the picture below.



Picture 3



Warning! Never look directly into the end of a fibre or a fibre connector that may be carrying laser light. Laser light, visible or invisible, can seriously injure eyes or even cause blindness.

6. The incoming cable is threaded through the centre opening. The method offers two cable tie fixing positions, see Picture 4.

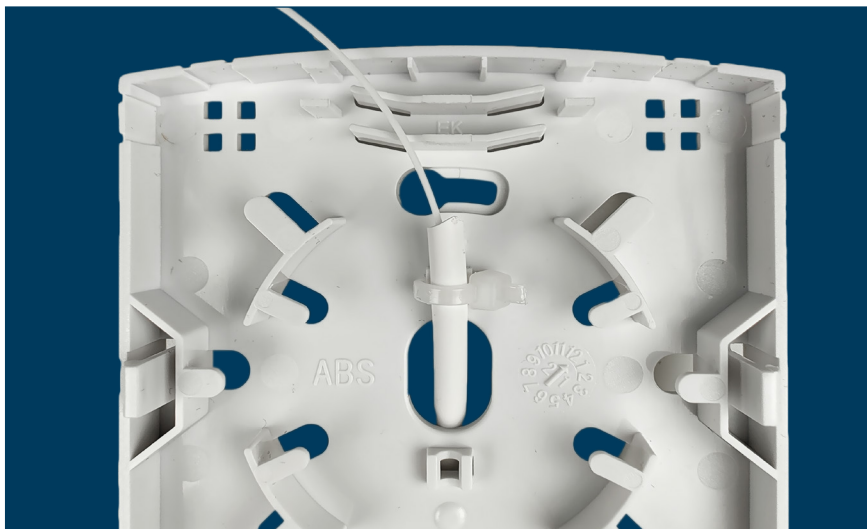

Picture 4

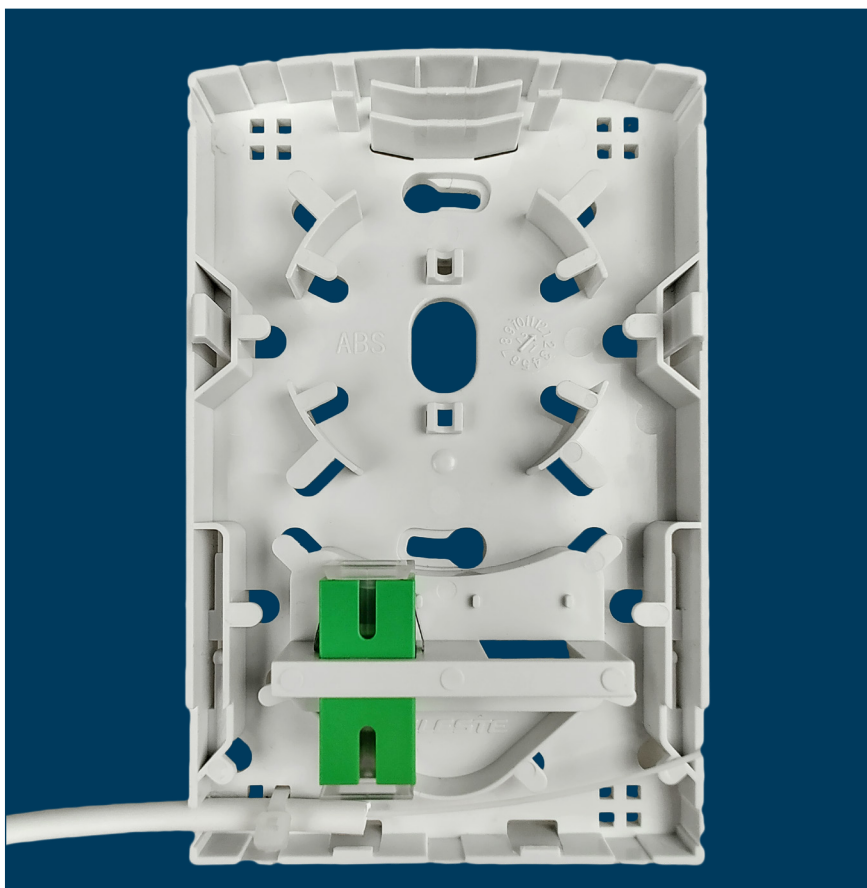

Picture 5

7. The cable is routed through the side of the back plate. The method provides cable tie fixings next to each entrance opening.



Note! Optical fibres should not be damaged. Cut the damaged fibre, and re-strip the fibre if an accident occurs.

8. Splice the drop cable with the pigtail, organize, and coil any excess cable around the radius limiter. Next, place the sleeve in the splice holder. Before inserting them into the adapter, ensure that both the pigtail and subscriber cable are cleaned properly.

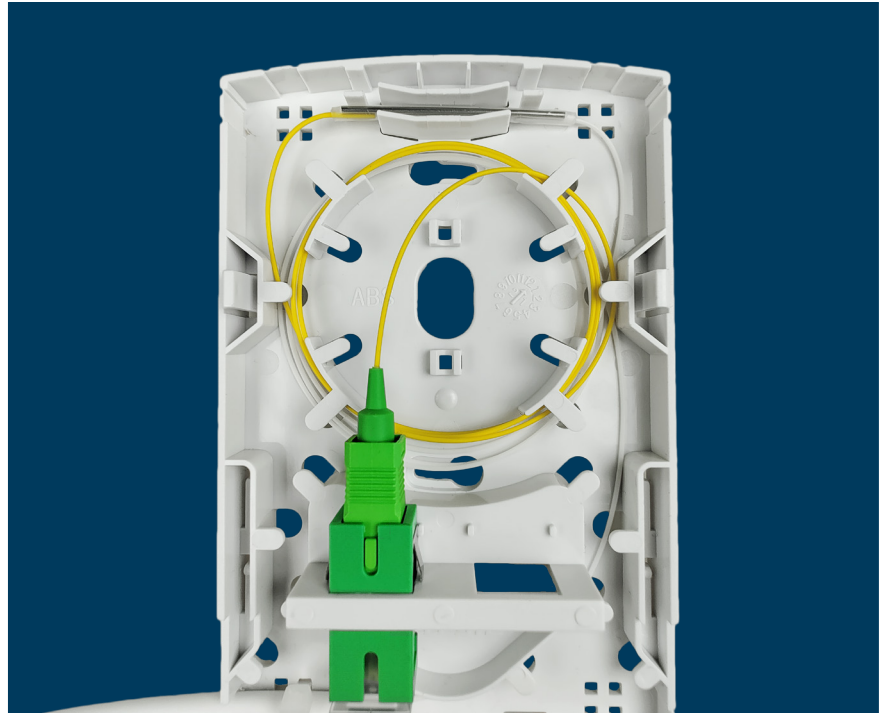

Picture 6



Picture 7

9. Place the lid back on to cover the splice and cables. Insert the FTTH subscriber cable into the adapter and pull down the protective lid.



Picture 8



TEN-FWO1 - Wall mounted.

Mounting Guidance

To perform a wall mount installation: Drill two holes in the wall based on the sizes in the mechanical layout drawing on page 2. Insert the expansion plugs, position the box to align with the holes, and secure it in place using bolts.

Legal Declarations

Copyright © 2024 Teleste Corporation. All rights reserved.

TELESTE is a registered trademark of Teleste Corporation. Other product and service marks are property of their respective owners.

This document is protected by copyright laws. Unauthorized distribution or reproduction of this document is strictly prohibited.

Teleste reserves the right to make changes to any of the products described in this document without notice and all specifications are subject to change without notice. Current product specifications are stated in the latest versions of detailed product specifications.

To the maximum extent permitted by applicable law, under no circumstances shall Teleste be responsible for any loss of data or income or any special, incidental, consequential or indirect damages howsoever caused.

The contents of this document are provided “as is”. Except as required by applicable law, no warranties of any kind, either express or implied, including, but not limited to, the implied warranties of merchantability and fitness for a particular purpose, are made in relation to the accuracy, reliability or contents of this document.

Teleste reserves the right to revise this document or withdraw it at any time without notice.



TELESTE

TELESTE CORPORATION

P.O.Box 323

FI-20101 Turku, Finland

www.teleste.com

Copyright © 2024 Teleste Corporation. All rights reserved. Teleste and the Teleste logo are registered trademarks of Teleste Corporation. Other product and service marks are property of their respective owners. Teleste reserves the right to make changes to any features and specifications of the products without prior notice. Although the information in this document has been reproduced in good faith, the contents of this document are provided "as is". Teleste makes no warranties of any kind in relation to the accuracy, reliability or contents of this document, except as required by applicable law.